

REAR COMBINATION LIGHT REMOVAL/INSTALLATION

B3E091851150W01

1. Disconnect the negative battery cable.
2. Remove the trunk end trim. (4SD) (See [TRUNK END TRIM REMOVAL/INSTALLATION](#).)
3. Remove the fasteners and slightly bend back the trunk side trim. (4SD)
4. Remove the service hole cover. (5HB)
5. Remove in the order indicated in the table.

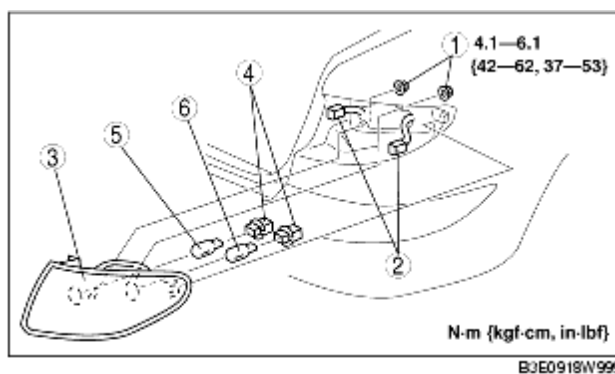

1	Nut
2	Connector
3	Rear combination light
4	Socket
5	Rear turn light bulb
6	Brake light/taillight bulb

6. Install in the reverse order of removal.